

Jukes & Co

Estate Agents



Holmesdale Road

, South Norwood, SE25 6PR

Offers Over £240,000



Stunning South-Facing One-Bedroom Victorian Conversion – Moments from Norwood Junction

This beautifully presented one-bedroom Victorian conversion flat is full of charm and finished to a high standard throughout, perfectly located just a short walk from Norwood Junction Station.

Highlights include:

- Bright and spacious lounge with large double-glazed windows and high-quality shutters
- Stylish modern kitchen with new Vaillant boiler
- Generous double bedroom with full-height fitted wardrobes
- Contemporary bathroom with smart hidden storage



Area Map

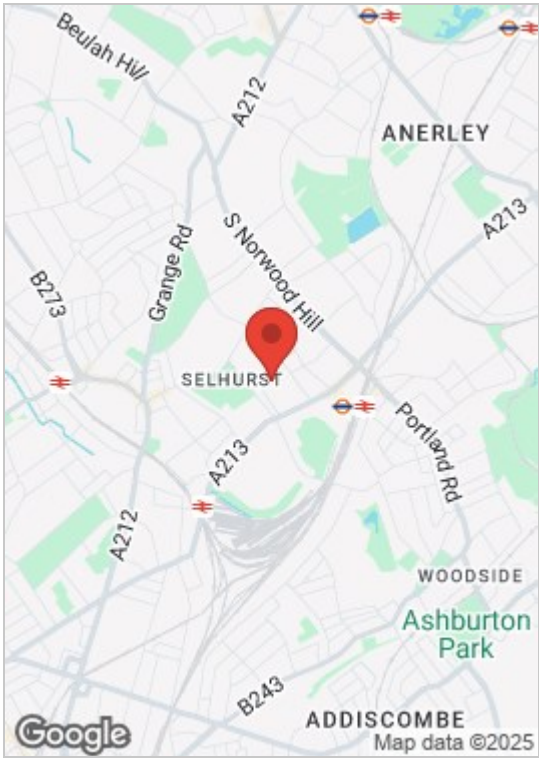

Floor Plan

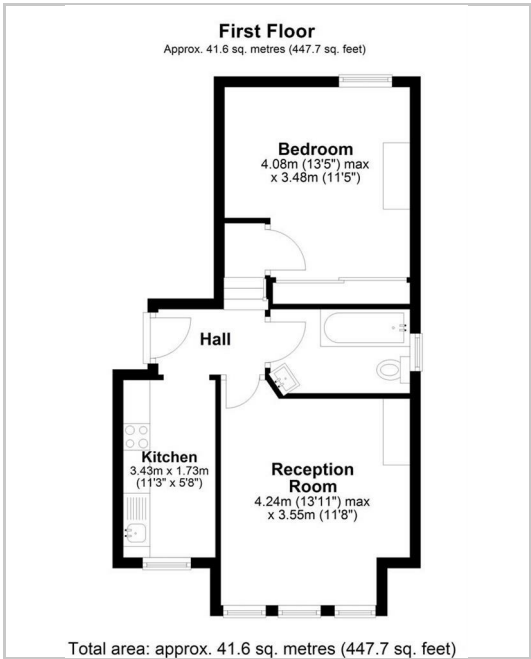

Energy Efficiency Graph

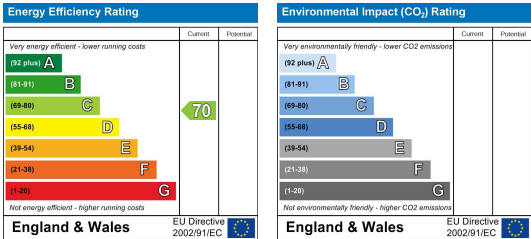

These particulars, whilst believed to be accurate are set out as a general outline only for guidance and do not constitute any part of an offer or contract. Intending purchasers should not rely on them as statements of representation of fact, but must satisfy themselves by inspection or otherwise as to their accuracy. No person in this firms employment has the authority to make or give any representation or warranty in respect of the property.